



Secured by Design



Police Preferred Specification

## pextra - the system with extra protection

In the pextra system, key security (key and cylinder are patented) is significantly increased by a key profile produced with a special milling procedure which greatly hinders manipulation. The pextra system is a premium locking system and is suitable for sophisticated master key systems with maximum security requirements.

### Function

- A specially designed keyway in the cylinder has tumbler pin pairs arranged both vertically and horizontally, and these must form a positive fit with the key to reach the shear plane required for opening.
- Burglary protection is significantly increased by the use of hardened elements. Vertically and horizontally arranged

locking elements and an overlapping profile increase keying code protection significantly.

- A mechanical device prevents the cylinder from being opened by the bumping method (certified).

### Safety Features

- Certified against the bumping methods (Rapido); the patented centering pin prevents the cylinder from being opened
- Meets EN1303 key related security grade 4-6 (depending on pin quality)
- Attack resistance Grade 2 optional on cylinder or in combination with security door furniture with cylinder cover, ÖNORM B5356 and DIN 18252, on request also according to VdS (classification data required)

### Your advantages in a glance:

- Double, single and thumbturn profile cylinders
- Full range of cylinder locks for furniture, key switches, elevator control, padlocks, camlocks and many more.
- All cylinder types can be integrated into master key systems.
- Profile families for flexible master key system capacity
- International certifications
- Patent protection until 2022
- Key blanks are not available in commercial trade
- Replacement keys available only from dormakaba or authorised dealers
- Dealer profiles are available for authorised partners
- Personal coinage for authorised dealers
- TrendKey and metal clip versions available
- Coloured key clips for organisation
- Transponder clip for Kaba digital and electronic access systems
- OEM cylinders available on request

- Suitable for use in fire and smoke protection doors
- The patented branch groove cannot be copied with standard milling machines.
- The optional active probe (blocking) on blocks in one direction with the branch groove is not present or was manipulated.

### Standard Configuration

- Six pin cylinder with up to 10 side entry pins plus blocking pin.
- Up to twelve hardened steel anti drill pins per cylinder and blocking pin where fitted.
- Patented centering pin (anti-bump)
- Available in Euro profile, UK Oval, Scandinavian Oval, Swiss Round, Round screw-in, Round Rim, Switch Locks, Cam, Office Furniture Locks and Padlocks.
- Single cylinder, double cylinder or cylinder and thumbturn.
- BS EN 1303 2005 certified for key related security 6 and for attack resistance to grade 2 for six pin cylinders.
- Blocking pin detects illegal key copies and prevents the key from being turned in the cylinder.
- Meets the requirements of BS 3621 and PAS 24 when used with a suitable lockcase or multipoint locking system.
- Six thumbturn options available; Round, Oval, Architectural, Freedom, Freedom EZ, and Anti-Ligature.
- Europe publication no. EP 1362153.
- International patents registered under WO 03/0004806
- Design protection until 2030

Finishes - available in nickel and satin brass as standard.

### Surface finishes - standard:

- nickel plated (NI = standard)
- standard brass (MS)

### On request:

- polished brass (MWP)
- chrome plated (CR)
- polished chrome plated (CRP)
- Light brown (BH)
- Medium Brown (BM)
- Dark Brown (BD)
- Dull Chrome (CRM)

**System Code PX** - without blocking pin

**System Code PXA** - with blocking pin.

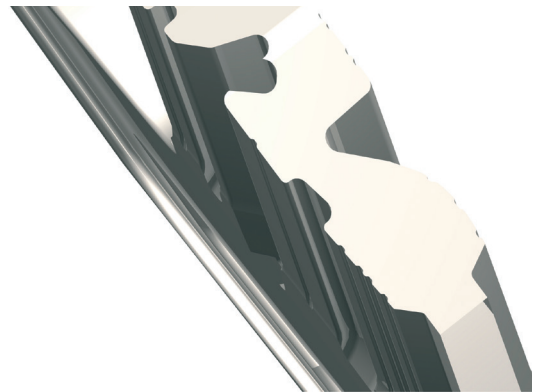

**pextra key profile with patented branch groove**



scan the QR code to learn more about pextra

### dormakaba UK & Ireland

Lower Moor Way  
Tiverton  
Devon  
EX16 6SS

T: +44 (0)870 000 5625  
E: [info.gb@dormakaba.com](mailto:info.gb@dormakaba.com)

[www.dormakaba.co.uk](http://www.dormakaba.co.uk)